

2/2-way solenoid valve for fluids

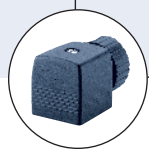

Type 6213 can be combined with...



Type 2508
Cable plug





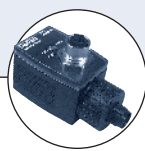

Type 1078
Timer unit



Type 2511
ASI cable plug



Type 8600
Dosing control

- Compact body from brass or stainless steel
- Push-over coil
- Waterhammer-free, low noise
- Diaphragm materials NBR, EPDM, FKM
- Approvals:     

The Type 6213 is a 2/2-way normally closed solenoid valve with a forced coupled diaphragm system. It switches from 1.5 PSI and can be used universally for fluids. For complete opening, a differential pressure of at least 1.5 PSI is necessary.

Power consumption			
Orifice DN [mm]	Inrush AC [VA]	Hold AC [VA/W]	DC [W]
10	34	14/8	10
13	36	14/8	10
20	38	14/8	10
25	160	38/18	–
40	202	38/18	–

Technical data	
Orifice	DN 10 – 40 mm
Body material	Brass, stainless steel 1.4404 (316L)
Inner part of valve	Brass body Stainless steel body
Seal material	NBR, FKM, EPDM
Media	NBR FKM EPDM
	Neutral fluids, water, hydraulic oil, oil without additives Per-solutions, hot oils with additives Oil and fat-free fluids
Ambient temperature	Max. 131°F (+55°C)
Media temperature	NBR FKM EPDM
	14°F to 176°F (-10°C to +80°C) 32°F to 194°F (0°C to +90°C) -22°F to 248°F (-30°C to +120°C)
Voltage tolerance	±10%
Duty cycle	100% continuous rating
Electrical connection	Tag connector acc. to DIN 43650 Form A for cable plug Type 2508 (see Accessories)
Protection class	IP 65 with cable plug
Installation	As required, preferably with actuator upright
Response times¹⁾	0.1 - 4 seconds (depending on orifice size and differential pressure)

¹⁾ Measured at valve outlet at 87 PSI and 68°F (+20°C)

Opening: pressure build-up 0 to 90%

Closing: pressure decay 100 to 10%

Dimensions [mm]

G Thread			AC coil			DC coil			DC and AC coil		
DN	G	F	B	H	K	B	H	K	C	L (Brass/SS)	M
10	NPT 1/4	12	82.0	32	45	82.5	40	51	37.5	50/55	3.5
	NPT 3/8	12									
	NPT 1/2	14									
13	NPT 1/2	14	95.5	32	45	96.0	40	51	45.0	58/65	3.5
	NPT 3/4	16									
20	NPT 3/4	16	115.5	32	45	116.0	40	51	66.0	80/100	3.5
	NPT 1	18									
25	NPT 1	18	158.5	49	53	158.5	49	53	104.5	95/-	7.0
	NPT 1 1/4	20									
40	NPT 1 1/2	22	179.5	49	53	179.5	49	53	104.5	132/-	7.0
	NPT 2	24									

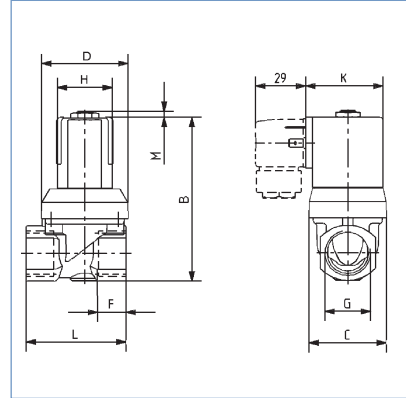

Specifications - ordering chart (other versions on request)

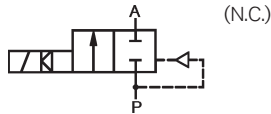

Brass body, NBR seal

U.L. Listed 
with 1/2" conduit plug Type 2509
0-250 V AC/DC

Port Connections [NPT]	Orifice [inch]	C _v	Pressure range [PSI]	Weight [lbs.]	Item no. Voltage / Frequency			
					24/DC	24/60	120/60	240/60
3/8	3/8	2.4	1.5 - 145	0.9	456 534	456 535	456 536	456 537
1/2	3/8	2.4	1.5 - 145	1.2	456 546	456 547	456 548	456 549
1/2	1/2	4.2	1.5 - 145	1.2	456 538	456 539	456 540	456 541
3/4	1/2	4.2	1.5 - 145	2.2	456 550	456 551	456 552	456 553
3/4	3/4	10.5	1.5 - 145	2.2	456 542	456 543	456 544	456 545
1	3/4	10.5	1.5 - 145	3.7	456 554	456 555	456 556	456 557
1	1	12.9	1.5 - 145	3.7	-	457 339	457 340	457 341
1 1/4	1	12.9	1.5 - 145	3.7	-	457 342	457 343	457 344
1 1/2	1 1/2	35.1	1.5 - 145	7.9	-	457 345	457 346	457 347
2	1 1/2	35.1	1.5 - 145	7.9	-	457 348	457 349	457 350

Brass body, FKM seal

Port Connections [NPT]	Orifice [inch]	C _v	Pressure range [PSI]	Weight [lbs.]	Item no. Voltage / Frequency			
					24/DC	24/60	120/60	240/60
3/8	3/8	2.4	1.5 - 145	0.9	456 558	456 559	456 560	456 561
1/2	1/2	4.2	1.5 - 145	1.2	456 562	456 563	456 564	456 565
3/4	3/4	10.5	1.5 - 145	2.2	456 566	456 567	456 568	456 569

Stainless steel body, FKM seal

Port Connections [NPT]	Orifice [inch]	C _v	Pressure range [PSI]	Weight [lbs.]	Item no. Voltage / Frequency			
					24/DC	24/60	120/60	240/60
1/4	3/8	2.4	1.5 - 145	0.9	458 796	458 797	458 798	458 799
3/8	3/8	2.4	1.5 - 145	0.9	458 800	458 801	458 802	458 803
1/2	1/2	4.2	1.5 - 145	1.2	458 804	458 805	458 806	458 807
3/4	3/4	10.5	1.5 - 145	2.2	458 808	458 809	458 810	458 811
1	3/4	10.5	1.5 - 145	3.7	458 812	458 813	458 814	458 815

Specifications – ordering chart (other versions on request) (continued)

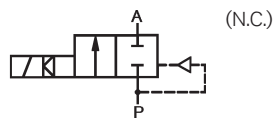

U.L. Recognized 
with standard-cable plug, Type 2508
0–250 V AC/DC

Brass body, NBR seal

Port Connections [NPT]	Orifice [inch]	C _v	Pressure range [PSI]	Weight [lbs.]	Item no. Voltage / Frequency			
					24/DC	24/60	120/60	240/60
1/4	3/8	2.4	1.5 – 145	0.9	458 078	458 079	458 080	458 081
3/8	3/8	2.4	1.5 – 145	0.9	456 439	456 440	456 441	456 442
1/2	3/8	2.4	1.5 – 145	1.2	456 449	456 450	456 451	456 452
1/2	1/2	4.2	1.5 – 145	1.2	458 443	456 444	456 300	456 445
3/4	1/2	4.2	1.5 – 145	2.2	456 453	456 454	456 455	456 456
3/4	3/4	10.5	1.5 – 145	2.2	456 446	456 447	456 301	456 448
1	3/4	10.5	1.5 – 145	3.7	456 457	456 458	456 302	456 659
1	1	12.9	1.5 – 145	3.7	–	457 163	457 164	457 165
1 1/4	1	12.9	1.5 – 145	3.7	–	457 166	457 167	457 168
1 1/2	1 1/2	35.1	1.5 – 145	7.9	–	457 169	457 170	457 171
2	1 1/2	35.1	1.5 – 145	7.9	–	457 172	457 173	457 174

Brass body, FKM seal

Port Connections [NPT]	Orifice [inch]	C _v	Pressure range [PSI]	Weight [lbs.]	Item no. Voltage / Frequency			
					24/DC	24/60	120/60	240/60
1/4	3/8	2.4	1.5 – 145	0.9	458 082	458 083	458 084	458 085
3/8	3/8	2.4	1.5 – 145	0.9	456 460	456 461	456 462	456 463
1/2	1/2	4.2	1.5 – 145	1.2	456 464	456 465	456 466	456 467
3/4	3/4	10.5	1.5 – 145	2.2	456 468	456 469	456 470	456 471

Stainless steel body, FKM seal

Port Connections [NPT]	Orifice [inch]	C _v	Pressure range [PSI]	Weight [lbs.]	Item no. Voltage / Frequency			
					24/DC	24/60	120/60	240/60
1/4	3/8	2.4	1.5 – 145	0.9	458 732	458 733	458 734	458 735
3/8	3/8	2.4	1.5 – 145	0.9	458 736	458 737	458 738	458 739
1/2	1/2	4.2	1.5 – 145	1.2	458 740	458 741	458 742	458 743
3/4	3/4	10.5	1.5 – 145	2.2	458 744	458 745	458 746	458 747
1	3/4	10.5	1.5 – 145	3.7	458 748	458 749	458 750	458 751

Specifications - ordering chart (other versions on request)

U.L. Listed 
with 1/2" conduit plug Type 2509
0-250 V AC/DC

Brass body, EPDM seal

Port Connections [NPT]	Orifice [inch]	C _v	Pressure range [PSI]	Weight [lbs.]	Item no. Voltage / Frequency			
					24/DC	24/60	120/60	240/60
3/8	3/8	2.4	1.5 - 145	0.9	457 187	457 188	457 189	457 190
1/2	1/2	2.4	1.5 - 145	1.2	457 191	457 192	457 193	457 194
3/4	3/4	10.5	1.5 - 145	2.2	457 195	457 196	457 197	457 198
1	1	12.9	1.5 - 145	3.7	-	457 351	457 352	457 353
1 1/4	1	12.9	1.5 - 145	3.7	-	457 354	457 355	457 356
1 1/2	1 1/2	35.1	1.5 - 145	7.9	-	457 357	457 358	457 359
2	1 1/2	35.1	1.5 - 145	7.9	-	457 360	457 361	457 362

Stainless steel body, EPDM seal

Port Connections [NPT]	Orifice [inch]	C _v	Pressure range [PSI]	Weight [lbs.]	Item no. Voltage / Frequency			
					24/DC	24/60	120/60	240/60
1/4	3/8	2.4	1.5 - 145	0.9	458 776	458 777	458 778	458 779
3/8	3/8	2.4	1.5 - 145	0.9	458 780	458 781	458 782	458 783
1/2	1/2	4.2	1.5 - 145	1.2	458 784	458 785	458 786	458 787
3/4	3/4	10.5	1.5 - 145	2.2	458 788	458 789	458 790	458 791
1	3/4	10.5	1.5 - 145	3.7	458 792	458 792	458 794	458 795

U.L. Recognized 
with standard-cable plug, Type 2508
0-250 V AC/DC

Brass body, EPDM seal

Port Connections [NPT]	Orifice [inch]	C _v	Pressure range [PSI]	Weight [lbs.]	Item no. Voltage / Frequency			
					24/DC	24/60	120/60	240/60
1/4	3/8	2.4	1.5 - 145	0.9	458 086	458 087	458 088	458 089
3/8	3/8	2.4	1.5 - 145	0.9	457 175	457 176	457 177	457 178
1/2	1/2	4.2	1.5 - 145	1.2	457 179	457 180	457 181	457 182
3/4	3/4	10.5	1.5 - 145	2.2	457 183	457 184	457 185	457 186
1	1	12.9	1.5 - 145	3.7	457 984	457 234	457 235	457 236
1 1/4	1	12.9	1.5 - 145	3.7	457 985	457 237	457 238	457 239
1 1/2	1 1/2	35.1	1.5 - 145	7.9	457 986	457 240	457 241	457 242
2	1 1/2	35.1	1.5 - 145	7.9	457 987	457 243	457 244	457 245

Stainless steel body, EPDM seal

Port Connections [NPT]	Orifice [inch]	C _v	Pressure range [PSI]	Weight [lbs.]	Item no. Voltage / Frequency			
					24/DC	24/60	120/60	240/60
1/4	3/8	2.4	1.5 - 145	0.9	458 712	458 713	458 714	458 715
3/8	3/8	2.4	1.5 - 145	0.9	458 716	458 717	458 718	458 719
1/2	1/2	4.2	1.5 - 145	1.2	458 720	458 721	458 722	458 723
3/4	3/4	10.5	1.5 - 145	2.2	458 724	458 725	458 726	458 727
1	3/4	10.5	1.5 - 145	3.7	458 728	458 729	458 730	458 731

In case of special application conditions,
please consult for advice.

We reserve the right to make technical changes without notice.
© Christian Bürkert GmbH & Co. KG

0810/3_US-en_1000082446