

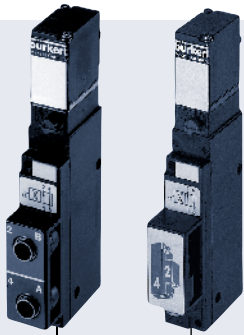

3/2 and 4/2-way Solenoid Valve for pneumatic systems



- Compact design in 3 and 4-way versions
- Manifold mounting
- Reduced power consumption
- High cycle rocker pilot
- Different pneumatic connections available
- Approvals: 

Type 5470 M can be combined with...



Type 2506
Cable plug

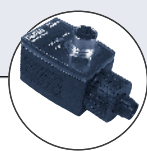

Type 2510/2511
ASI cable plug

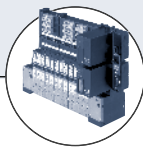

Type 8640
Valve island



Type 2000
Angle-seat valve

The Type 5470 is available as a 3/2 and 4/2-way valve. Both circuit function versions can be mounted on a single pneumatic module. Numerous variants exist for service ports 2 and 4.

Technical data	
Orifice	DN 4.0 mm
Body material	Polyamide (PA)
Valve internal	Ultramide
Seal material	NBR
Media	Compressed air, neutral gases
Media temperature	14°F to 122°F (-10°C to +50°C)
Ambient temperature	14°F to 131°F (-10°C to +50°C)
Port connection 1 to 4 (Version)	NPT 1/8 push-in connection Ø 1/4 IN, Ø 6 mm
Voltage tolerance	± 10%
Power consumption	1W, 2W, 3W (Refer to the effective coil power in the ordering chart.)
Duty cycle	100% continuous rating
Electrical connection	Tag connector acc. to DIN 43 650 Form C
Protection class	IP 65 (with cable plug)
Type of protection	EEx ia II C T6, FM class 1, Div 1 on request
Installation	As required, preferably with actuator upright

Dimensions [mm]

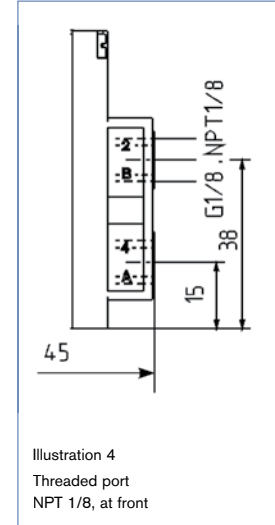
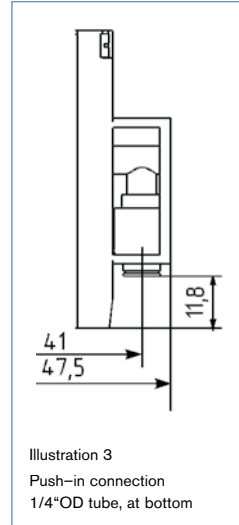
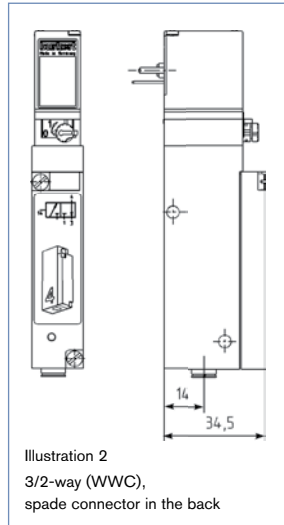
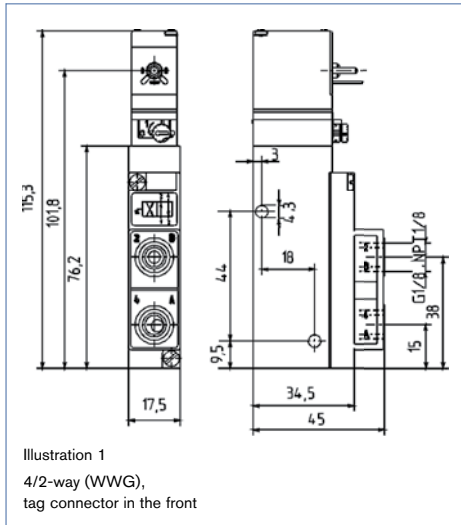

Ordering chart for valves (other versions on request)

All valves with NBR seal material, supply connections 1 and 3 as flange models, without cable plug (see Accessories), manifold assembly, valve with tag connector in the front, connection with cable plug Type 2506 (see Accessories) valve manifold mounting, valve with tag connector in the back, connection with integrated connecting sockets on valve blocks Type 8640.

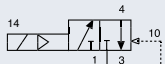
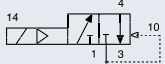
Circuit function	Orifice [mm]	C _v	QN value air [l/min]	Service ports 4 and 2	Pressure range [PSI]	Voltage/frequency [V/Hz]	Effective coil power [W]	Item no. Spade connector in the rear for valve blocks Type 8640	Item no. Spade connector in the front for valve blocks with cable plugs
C 3/2-way valve NC 	4.0	.32	300	Push-in connection 1/4" OD tube, underneath (Illustration 2)	29 – 100	024/DC	1	456707	US09571
						024/DC	2	457737	US09572
						110-120/DC	3	456708	US09573
						220-240/DC	3	456709	US09574
G 4/2-way valve 	4.0	.32	300	Push-in connection 1/4" OD tube, underneath (Illustration 3)	29 – 100	024/DC	1	456713	US09575
						024/DC	2	457738	US09576
						110-120/DC	3	456714	US09577
						220-240/DC	3	456715	US09578
				Threaded port NPT 1/8, in the front (Illustration 1, 4)	29 – 100	024/DC	1	456716	US09579
						024/DC	2	457739	US09580
						110-120/DC	3	456717	US09581
						220-240/DC	3	456718	US09582
Threaded port NPT 1/8, in the front with integrated flow restrictors	29 – 100	024/DC	1	456728	US09583				
		024/DC	2	457740	US09584				
		110-120/DC	3	456729	US09585				
						220-240/DC	3	456730	US09586

When operating with alternating current, use a cable plug Type 2506 with an integral rectifier. See accessories. 3/2-way, circuit function D, (normally open) without power on request.

Manifold assembly from pneumatic modules Type MP05

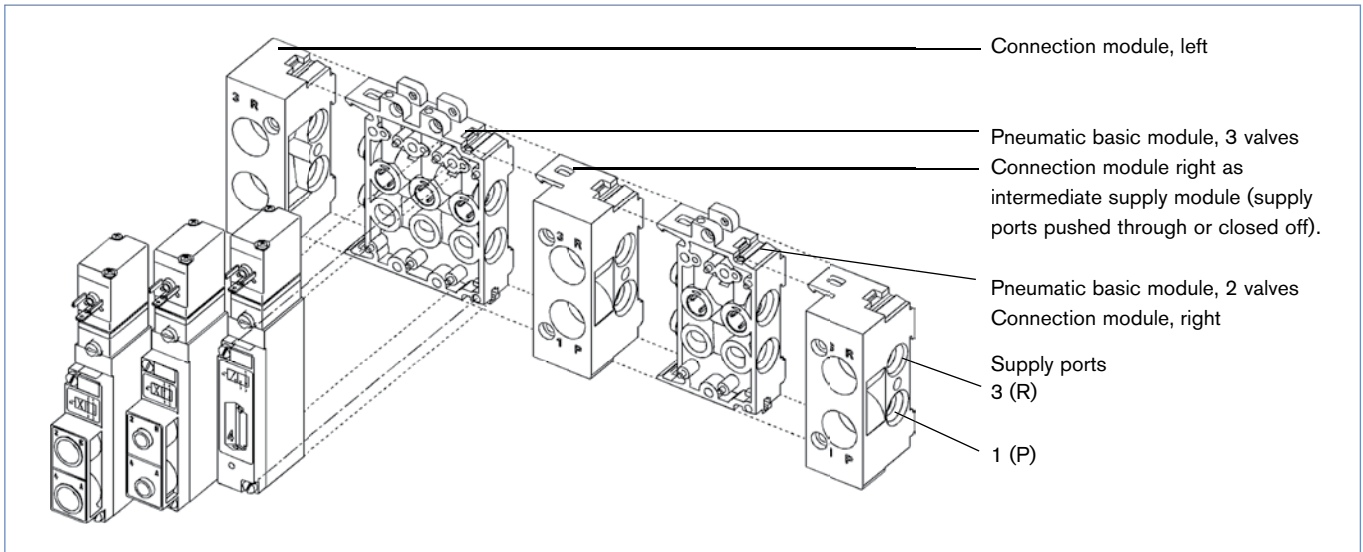

Note when ordering complete valve blocks:

Please list the modules in the block assembly from right to left, as shown in the ordering example.

Ordering example for Type 5470 with Type MP05		
No.	Unit	Item no.
1	Connection module right, NPT 1/8, G 1/8	132 575
1	Pneumatic basic module, 2 valves	132 516
1	Pneumatic basic module, 3 valves	132 517
1	Connection module left, NPT 1/8, G 1/8	132 513
5	Valves	US09576

Manifold assembly either wall-mounted or standard mounting DIN rail 50022

Valve assembly on pneumatic modules Type MP05 using the supplied M3 screws.

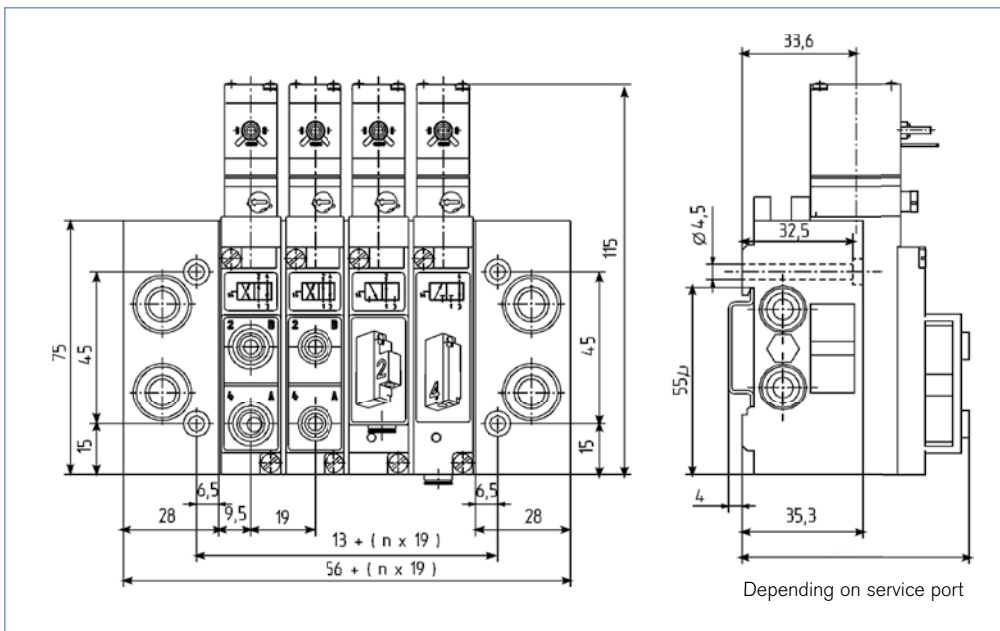

Accessories

Ordering chart for Type MP05 pneumatic modules

Version	Item no.
Connection module left, NPT 1/8	133 176
Connection module left, G 1/8	133 175
Connection module left, NPT 1/4	132 513
Connection module left, G 1/4	132 512
Connection module right, NPT 1/8	133 178
Connection module right, G 1/8	133 177
Connection module right, NPT 1/4	132 515
Connection module right, G 1/4	132 514
Pneumatic basic module, 2 valves	132 516
Pneumatic basic module, 3 valves	132 517
Pneumatic basic module, 2 valves with check valve	132 518
Pneumatic basic module, 3 valves with check valve	132 519

Ordering chart for cable plug Type 2506

Version	Item no.
No circuitry, 0–250 V	008 353 P
With LED, 12–24 V	008 402 A
With LED, 100–120 V	008 403 B
With LED, 200–240 V	008 404 C
With rectifier, LED, varistor, 12–24 V	008 354 Q
With rectifier, LED, varistor, 100–120 V	008 355 R
With rectifier, LED, varistor, 200–240 V	008 356 J
With LED and varistor, 12–24 V	008 408 Q
With LED and varistor, 100–120 V	008 409 R
With LED and varistor, 200–240 V	008 410 D
With pole protection, supressor diode, LED 12–24 V	008 411 S
With rectifier and varistor, 12–240 V	008 412 T

Ordering chart for accessories for Type Mp05 pneumatic modules

Accessory part	Features	Item no.
Connection module G 1/8	intermediate supply	643 019
Connection module NPT 1/8	intermediate supply	643 028
Blanking plug	NPT 1/8	US61335
Blanking plug for push-in connection	1/4" OD tube	US1055
Covering plate (black)	for unused valve positions	643 223
Indicating tags	64 pieces	623 816

INDUSTRIAL DYNAMICS CO

1-800-940-0453

In case of special application conditions,
please consult for advice.

We reserve the right to make technical
changes without notice.

0602/2_US-en